



THE FOLLOWING ARE REQUIREMENTS PER DEPARTMENT OF HEALTH

WATER MAIN GENERAL REQUIREMENTS:

- 1. WATER MAINS SHALL BE INSTALLED IN ACCORDANCE WITH THE DEPARTMENT OF HEALTH REQUIREMENTS FOR WATER MAINS.
- 2. WATER MAINS SHALL BE INSTALLED IN ACCORDANCE WITH THE DEPARTMENT OF HEALTH REQUIREMENTS FOR WATER MAINS.
- 3. WATER MAINS SHALL BE INSTALLED IN ACCORDANCE WITH THE DEPARTMENT OF HEALTH REQUIREMENTS FOR WATER MAINS.
- 4. WATER MAINS SHALL BE INSTALLED IN ACCORDANCE WITH THE DEPARTMENT OF HEALTH REQUIREMENTS FOR WATER MAINS.
- 5. WATER MAINS SHALL BE INSTALLED IN ACCORDANCE WITH THE DEPARTMENT OF HEALTH REQUIREMENTS FOR WATER MAINS.
- 6. WATER MAINS SHALL BE INSTALLED IN ACCORDANCE WITH THE DEPARTMENT OF HEALTH REQUIREMENTS FOR WATER MAINS.

GENERAL NOTES:

1. THE CONTRACTOR SHALL BE RESPONSIBLE FOR OBTAINING ALL NECESSARY PERMITS FROM THE APPROPRIATE AGENCIES.
2. THE CONTRACTOR SHALL BE RESPONSIBLE FOR PROTECTING ALL EXISTING UTILITIES AND STRUCTURES.
3. THE CONTRACTOR SHALL BE RESPONSIBLE FOR MAINTAINING ACCESS TO ALL ADJACENT PROPERTIES.
4. THE CONTRACTOR SHALL BE RESPONSIBLE FOR RESTORING ALL EXISTING CONDITIONS TO ORIGINAL OR BETTER.
5. THE CONTRACTOR SHALL BE RESPONSIBLE FOR PROVIDING ALL NECESSARY EROSION CONTROL MEASURES.
6. THE CONTRACTOR SHALL BE RESPONSIBLE FOR PROVIDING ALL NECESSARY SAFETY MEASURES.

GENERAL NOTES:

1. THE CONTRACTOR SHALL BE RESPONSIBLE FOR OBTAINING ALL NECESSARY PERMITS FROM THE APPROPRIATE AGENCIES.
2. THE CONTRACTOR SHALL BE RESPONSIBLE FOR PROTECTING ALL EXISTING UTILITIES AND STRUCTURES.
3. THE CONTRACTOR SHALL BE RESPONSIBLE FOR MAINTAINING ACCESS TO ALL ADJACENT PROPERTIES.
4. THE CONTRACTOR SHALL BE RESPONSIBLE FOR RESTORING ALL EXISTING CONDITIONS TO ORIGINAL OR BETTER.
5. THE CONTRACTOR SHALL BE RESPONSIBLE FOR PROVIDING ALL NECESSARY EROSION CONTROL MEASURES.
6. THE CONTRACTOR SHALL BE RESPONSIBLE FOR PROVIDING ALL NECESSARY SAFETY MEASURES.

GENERAL NOTES:

1. THE CONTRACTOR SHALL BE RESPONSIBLE FOR OBTAINING ALL NECESSARY PERMITS FROM THE APPROPRIATE AGENCIES.
2. THE CONTRACTOR SHALL BE RESPONSIBLE FOR PROTECTING ALL EXISTING UTILITIES AND STRUCTURES.
3. THE CONTRACTOR SHALL BE RESPONSIBLE FOR MAINTAINING ACCESS TO ALL ADJACENT PROPERTIES.
4. THE CONTRACTOR SHALL BE RESPONSIBLE FOR RESTORING ALL EXISTING CONDITIONS TO ORIGINAL OR BETTER.
5. THE CONTRACTOR SHALL BE RESPONSIBLE FOR PROVIDING ALL NECESSARY EROSION CONTROL MEASURES.
6. THE CONTRACTOR SHALL BE RESPONSIBLE FOR PROVIDING ALL NECESSARY SAFETY MEASURES.

GENERAL NOTES:

1. THE CONTRACTOR SHALL BE RESPONSIBLE FOR OBTAINING ALL NECESSARY PERMITS FROM THE APPROPRIATE AGENCIES.
2. THE CONTRACTOR SHALL BE RESPONSIBLE FOR PROTECTING ALL EXISTING UTILITIES AND STRUCTURES.
3. THE CONTRACTOR SHALL BE RESPONSIBLE FOR MAINTAINING ACCESS TO ALL ADJACENT PROPERTIES.
4. THE CONTRACTOR SHALL BE RESPONSIBLE FOR RESTORING ALL EXISTING CONDITIONS TO ORIGINAL OR BETTER.
5. THE CONTRACTOR SHALL BE RESPONSIBLE FOR PROVIDING ALL NECESSARY EROSION CONTROL MEASURES.
6. THE CONTRACTOR SHALL BE RESPONSIBLE FOR PROVIDING ALL NECESSARY SAFETY MEASURES.

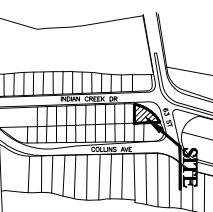
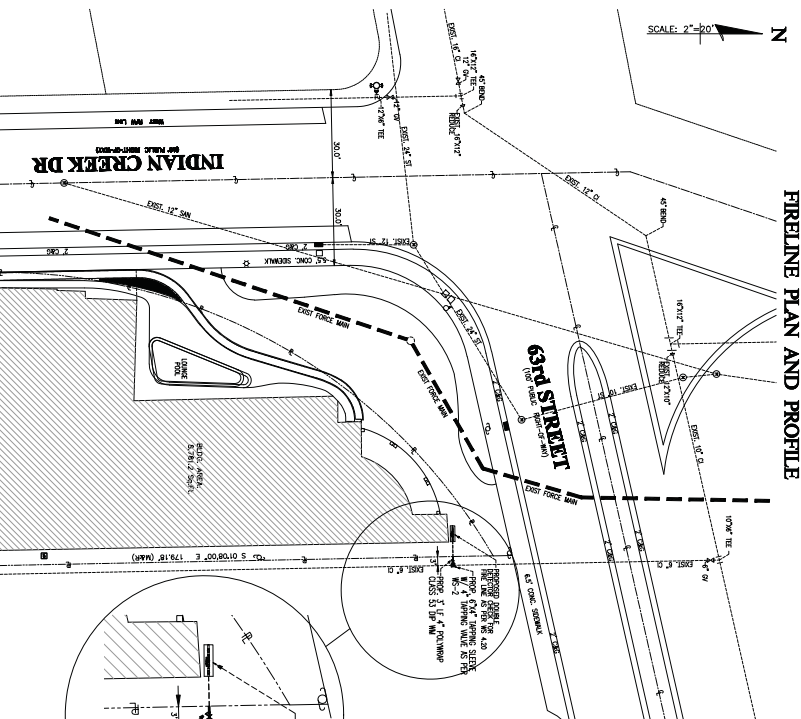

LEGAL DESCRIPTION:

Lot 24 and 25, of LITE G, HILL SIBBOLSON, according to the Plat thereof recorded in the Public Records of Missouri County, State of Missouri, Book 11, Page 11410 (FIELD No. 02 - 3211 - 006 - 0200)

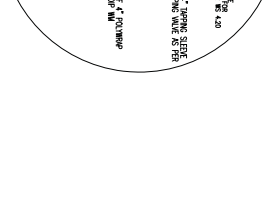

| Station | Profile | Notes |
|---------|---------|---------|
| 6 | 10.00 | MANHOLE |
| 5 | 9.50 | MANHOLE |
| 4 | 9.00 | MANHOLE |
| 3 | 8.50 | MANHOLE |
| 2 | 8.00 | MANHOLE |
| 1 | 7.50 | MANHOLE |
| 0 | 7.00 | MANHOLE |
| -1 | 6.50 | MANHOLE |
| -2 | 6.00 | MANHOLE |
| -3 | 5.50 | MANHOLE |

WATER MAIN PROFILE:

SCALE: HORIZ. 1" = 20' VERT. 1" = 2'

ENGINEERS NOTES:

1. CONTRACTOR SHALL BE RESPONSIBLE FOR OBTAINING ALL NECESSARY PERMITS FROM THE APPROPRIATE AGENCIES.
2. THE CONTRACTOR SHALL BE RESPONSIBLE FOR PROTECTING ALL EXISTING UTILITIES AND STRUCTURES.
3. THE CONTRACTOR SHALL BE RESPONSIBLE FOR MAINTAINING ACCESS TO ALL ADJACENT PROPERTIES.
4. THE CONTRACTOR SHALL BE RESPONSIBLE FOR RESTORING ALL EXISTING CONDITIONS TO ORIGINAL OR BETTER.
5. THE CONTRACTOR SHALL BE RESPONSIBLE FOR PROVIDING ALL NECESSARY EROSION CONTROL MEASURES.
6. THE CONTRACTOR SHALL BE RESPONSIBLE FOR PROVIDING ALL NECESSARY SAFETY MEASURES.